

C CHROMA

DISPLAY SHOP SYSTEM

DESIGN BY GEORG DRASER



MADE WITH PASSION

In the beginning was the problem: It existed – in our opinion there are no beautiful display systems for high quality kitchen knives. The displays currently on the market are designed from the fifties and are not as appealing or up to date as the knives are. This was the reason why CHROMA Cutlery asked the German designer Georg Draser to develop the ultimate shop display system. Chic but simple. Modular for every kind of need.

It tooks 2 years of development from the renowned designer Georg Draser from Münster in Germany for the CHROMA system to be finished. It was launched with celebrated and sensational success to the market at the Frankfurt Ambiente show 2006.

CHROMA

DISPLAY SHOP SYSTEM

DESIGN BY GEORG DRASER

SYSTEM ELEMENTS



measures: width x depth x height
72,6 x 44 x 7,5 cm

X01 cassette

- cassette with glass lid and magnetic rack with lock and key
- MDF plywood black coated
- plate stainless steel
- glass lid with lid holder
- magnetic rack with protection against scratches
- bottom with silicone feet
- bottom with holder for vertical fixing in the metal frame

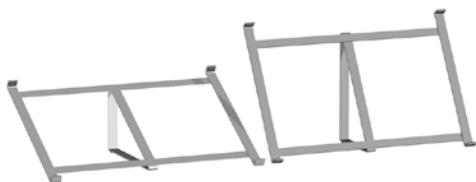

X02 stand for cassette

- metal coated in silver
- you can have at an angle of 30° or 60° degrees
- with silicone protection to protect the cassette



77 x 5 x 58 cm

X03 top vertical frame with logo and angle to fix on the wall

- frame: metal coated in silver
- logo: MDF black coated
- accessoires for installation on the wall and for installation of vertical cassette are included
- reverse with angle for optimal fixing



77 x 5 x 48 cm

X04 vertical frame

- frame: metal coated in silver
- installation kit for more frame elements and vertical cassette installation are included



77 x 46 x 48 cm
(+ feet, roller wheelset)

X05 bottom frame construction with feet

- frame vertical and horizontal: metal coated in silver
- feet: height adjustable and removable
- can be taken with cupboard X08 or shelf X11 (will be delivered without X11)



74,6 x 46 x 5 cm

X06 horizontal frame with "big" shelf

- frame: metal coated in silver
- shelf: plywood black coated
- installation kit for fixing on vertical frame is included



74,8 x 29 x 5 cm

X07 horizontal frame with "small" shelf

- frame: metal coated in silver
- shelf: plywood black coated
- only usable for cassette at an angle of 60° degrees
- installation kit for fixing on vertical frame is included



74,6 x 46 x 41 cm

X08 stock cupboard built in to the system

- cupboard shut with key
- corpus: plywood black coated
- front of the drawer: aluminium



74,6 x 46 x 48 cm

X09 stock cupboard free standing with basement

- cupboard locks with key
- cupboard frame: plywood black coated
- front of the drawer: aluminium
- you can put it for example under the wall displays (WA1, WA2, WA3)



size: 7,2 | Ø: 4,8 cm

X10 roller wheel set for cupboard x 4pcs

- feet can be replaced by rollers
- two of the four rollers have a fixing brake
- screws for installation are included



X11 shell for frame construction X05 and horizontal frame X06

- plywood black coated

POSSIBLE COMBINATIONS (examples)



version ST.h1

components:

- 3 x X01
- 1 x X02
- 1 x X03
- 2 x X04
- 1 x X05
- 1 x X06
- 1 x X08



version ST.h2

components:

- 3 x X01
- 2 x X02
- 1 x X03
- 2 x X04
- 1 x X05
- 1 x X06
- 1 x X07
- 1 x X08



version ST.h 3

components:

- 1 x X01
- 1 x X03
- 2 x X04
- 1 x X05
- 1 x X06
- 1 x X07
- 1 x X08



version ST.h 4

components:

- 1 x X01
- 1 x X03
- 2 x X04
- 1 x X05
- 1 x X06
- 1 x X07
- 1 x X11



version ST.n1

components:

- 2 x X01
- 1 x X02
- 1 x X03
- 1 x X04
- 1 x X05
- 1 x X06
- 1 x X08



version ST.n2

components:

- 2 x X01
- 2 x X02
- 1 x X03
- 1 x X04
- 1 x X05
- 1 x X06
- 1 x X07
- 1 x X08



version ST.n3

components:

- 2 x X01
- 1 x X02
- 1 x X03
- 1 x X04
- 1 x X05
- 1 x X06
- 1 x X11



version ST.n4

components:

- 1 x X03
- 1 x X04
- 1 x X05
- 1 x X06
- 1 x X07
- 1 x X11

ASSEMBLING

1

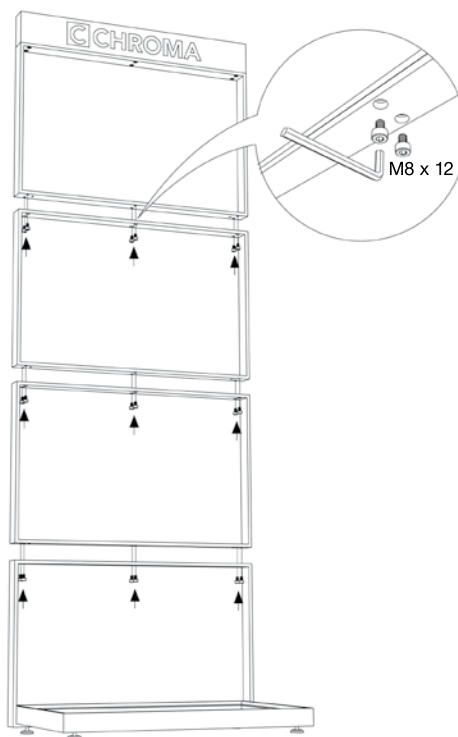

2

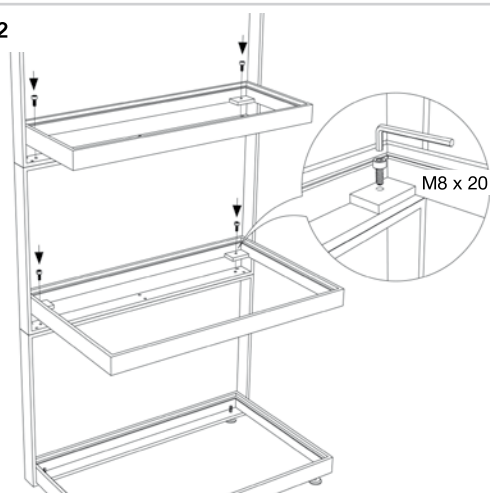

3

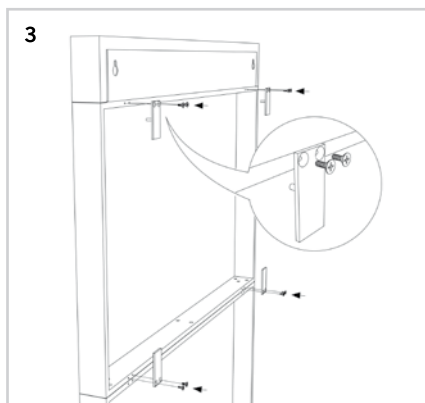

4

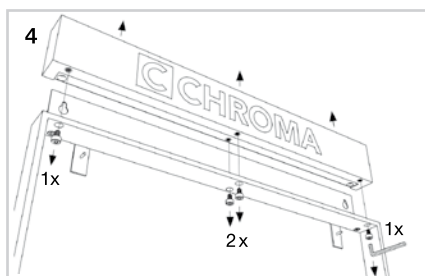

5

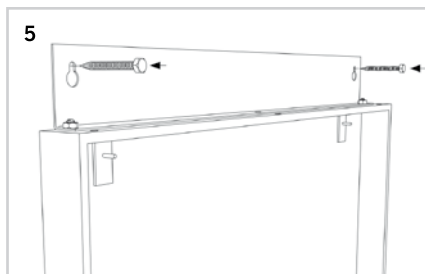

6

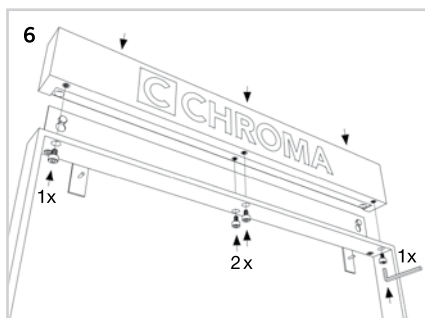

POSSIBLE COMBINATIONS (examples)



version WA1

components:

- 1 x X01
- 1 x X03



version WA2

components:

- 1 x X01 1 x X03
- 1 x X02 1 x X07



version WA3

components:

- 1 x X01 1 x X03
- 1 x X02 1 x X06

ASSEMBLING

